



12.2m X 3.9m, 2 BEDROOM POD

\$158,960 inc GST

POD:1239-P3

Tailored for families or couples, this two-bedroom transportable building boasts a central bathroom, a U-shaped kitchen, and wardrobe storage, maximising both comfort and practicality. With its efficient use of space and modern amenities, it offers a cosy and functional living environment for those looking for a compact yet comfortable home.

SPECIFICATIONS: 12.2m X 3.9m, 2 BEDROOM POD

External Dimensions	12.2m x 3.9m
Footprint	47m2
Exterior Cladding	Colorsteel Maxx
Glazing	Double
Ranch Slider (with opening sash windows)	✓
Power	32A Junction Box
Insulation Values	Roof 7.5, Wall 2.1, Floor 3.3 (exceeds NZ Building Code)
Flooring	Wide Plank Vinyl 2.5mm
Lighting	LED
Internal Lights	12
External Lights	1
Double Power Points	15
Single Power Points	Optional
USB	Optional
External Timber Screen	✓
Internal Timber Panels	Optional

Benchtop	Laminate (Engineered stone option)
Blinds	Optional
Washing Machine Connection	✓
Electrical Code of Compliance Certificate	✓
Gas Code of Compliance Certificate	✓
Shower	✓
Bathroom Vanity	✓
Bathroom Extractor Fan	✓
Mirrored Storage Cabinet	✓
Wardrobe in Master Bedroom	✓
Electric Hob	✓
Ducted Rangehood	✓
Smoke Alarm	✓
Pod Code of Compliance Certificate	✓
16L Rinnai Gas Califont	✓

FRONT & INTERIOR VIEW: 12.2M X 3.9M, 2 BEDROOM POD



FLOORPLAN: 12.2M X 3.9M, 2 BEDROOM POD

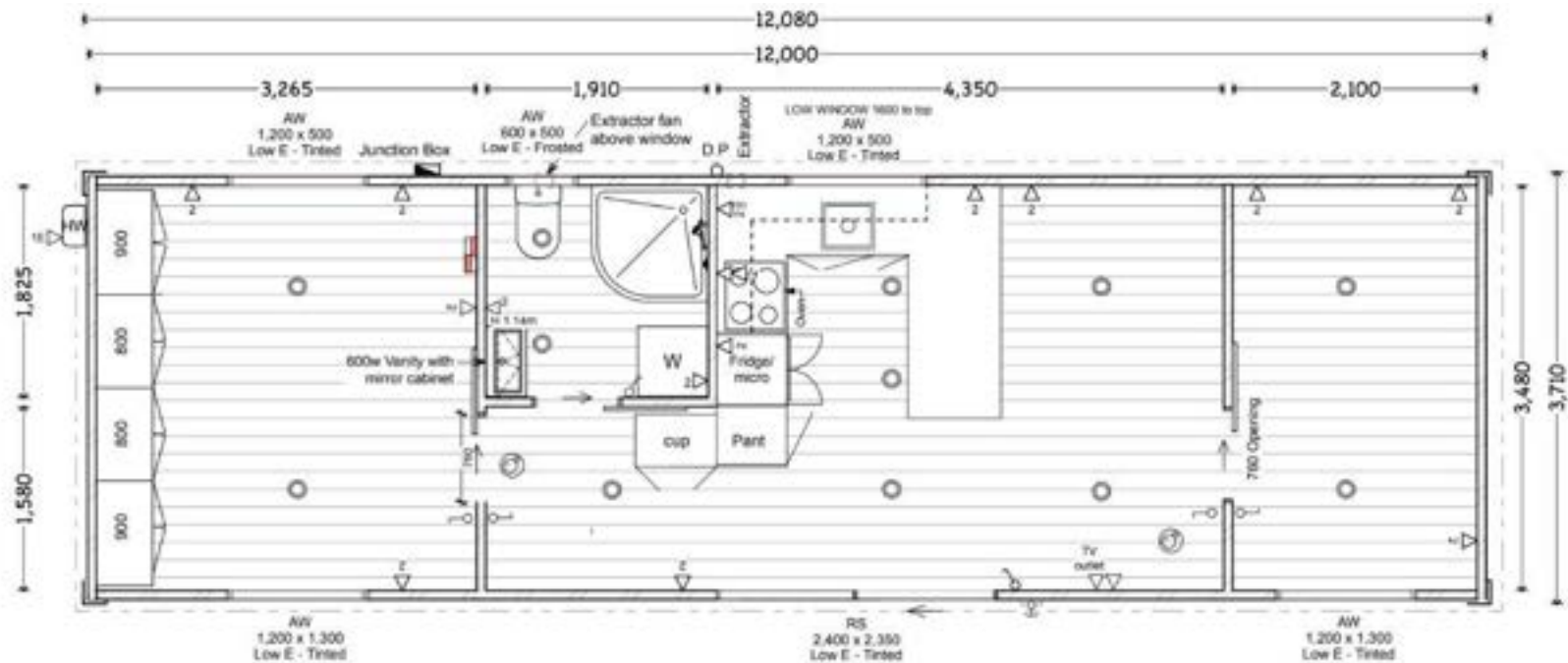

<p>NOTES: Risk Group - SH NZBC C1/A5.1 Applies. In general all construction to comply with the NZ Building code and all relevant NZIA standards whether detailed on the plans or not.</p> <p>POOLIFE SPECIFICATIONS: SMOKE ALARMS: Smoke alarms to be fitted in accordance with NZBC F7/A5.1 and NZ4514.</p> <p>ELECTRICAL: IPX4 (min) rated caravan plugs pre-installed into PODs by Certified Electrician. PODs shall be shipped with electrical certification.</p>	<p>ELECTRICAL KEY:</p> <ul style="list-style-type: none"> Double Switch Light switch Dimmer Light Switch Double plug Externally rated dble plug 1.5m high Ceiling mounted LED light 	<ul style="list-style-type: none"> External Wall light Smoke alarm Distribution Board Caravan plug - in 2.3m high Junction box - in 0.3m high Water feed inlet Washing machine taps (install double waste) 	<p>WINDOW CODES:</p> <ul style="list-style-type: none"> FRL Frosted / Obscure glass Tgh Toughened glass AW Awning R/S Ranch slider <p>(All windows to be double glazed)</p>
---	--	---	--

1239 - P3 - LH

PLOT: 7/03/24