



12.2m X 3.9m, 3 BEDROOM POD

\$159,690 inc GST

POD:1239-P2

Perfect for families looking, this three-bedroom transportable building offers a kitchen, family bathroom, and wardrobe storage in each room. With its thoughtful layout and ample storage, it provides a comfortable and organized living

SPECIFICATIONS: 12.2m X 3.9m, 3 BEDROOM POD

External Dimensions	12.2m x 3.9m
Footprint	47m2
Exterior Cladding	Colorsteel Maxx
Glazing	Double
Ranch Slider (with opening sash windows)	✓
Power	32A Junction Box
Insulation Values	Roof 7.5, Wall 2.1, Floor 3.3 (exceeds NZ Building Code)
Flooring	Wide Plank Vinyl 2.5mm
Lighting	LED
Internal Lights	10
External Lights	1
Double Power Points	12
Single Power Points	Optional
USB	Optional
External Timber Screen	✓
Internal Timber Panels	Optional

Benchtop	Laminate (Engineered stone option)
Blinds	Optional
Washing Machine Connection	Optional
Electrical Code of Compliance Certificate	✓
Gas Code of Compliance Certificate	✓
Shower	✓
Bathroom Vanity	✓
Bathroom Extractor Fan	✓
Mirrored Storage Cabinet	✓
Wardrobe in Master Bedroom	✓
Electric Hob	✓
Ducted Rangehood	✓
Smoke Alarm	✓
Pod Code of Compliance Certificate	✓
16L Rinnai Gas Califont	✓

FRONT & INTERIOR VIEW: 12.2M X 3.9M, 3 BEDROOM POD



FLOORPLAN: 12.2M X 3.9M, 3 BEDROOM POD

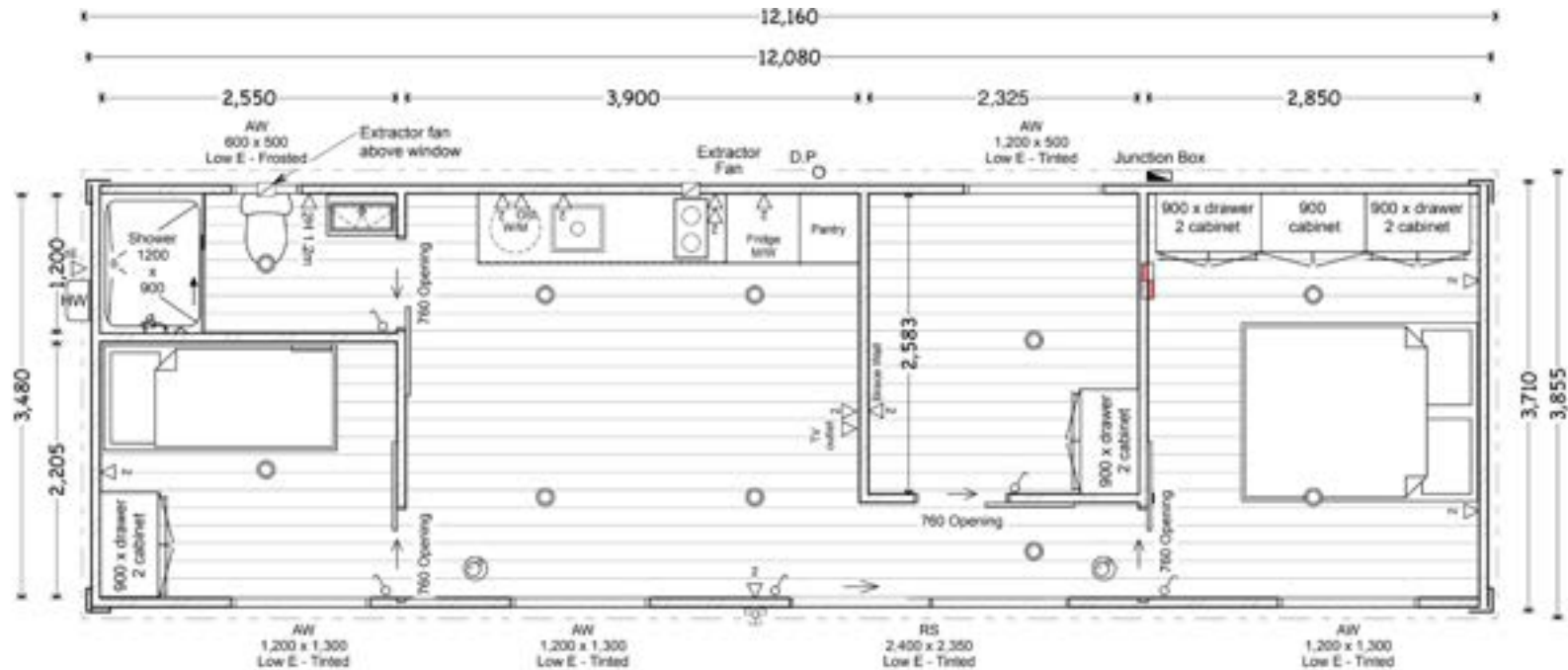

NOTES:

Risk Group - SH NZBC C1/AS1 Applies.
In general all construction to comply with the NZ Building code and all relevant NZ/A standards whether detailed on the plans or not.

POOLIFE SPECIFICATIONS:

SMOKE ALARMS:

Smoke alarms to be fitted in accordance with NZBC F1/AS1 and NZ4514.

ELECTRICAL:

IPX4 (min) rated caravan plugs pre-installed into PODs by Certified Electrician. PODs shall be shipped with electrical certification.

ELECTRICAL KEY:

- Double Switch
- Light switch
- Dimmer Light Switch
- Double plug
- Externally rated dble plug 1.5m high
- Ceiling mounted LED light

- External Wall light
- Smoke alarm
- Distribution Board
- Caravan plug - in 2.3m high
- Junction box - in 0.5m high
- Water feed inlet
- Washing machine taps (install double waste)

WINDOW CODES:

- FRL Frosted / Obscure glass
- Tgh. Toughened glass
- AW Awning
- R/S Ranch slider

(All windows to be double glazed)

1239 - P2 - LH

PLOT: 7/03/24